

JAMES EDWARD

Comprehensively Cared For

Mountgrove Road
London, N5 2LS

Offers In Excess Of £900,000



Mountgrove Road

, London, N5 2LS

Extremely well presented three bedroom, split level upper maisonette with private terrace and landscaped garden, ideally located with close proximity of the local amenities in Highbury and Finsbury Park.

[Full description](#)





Floor Plan

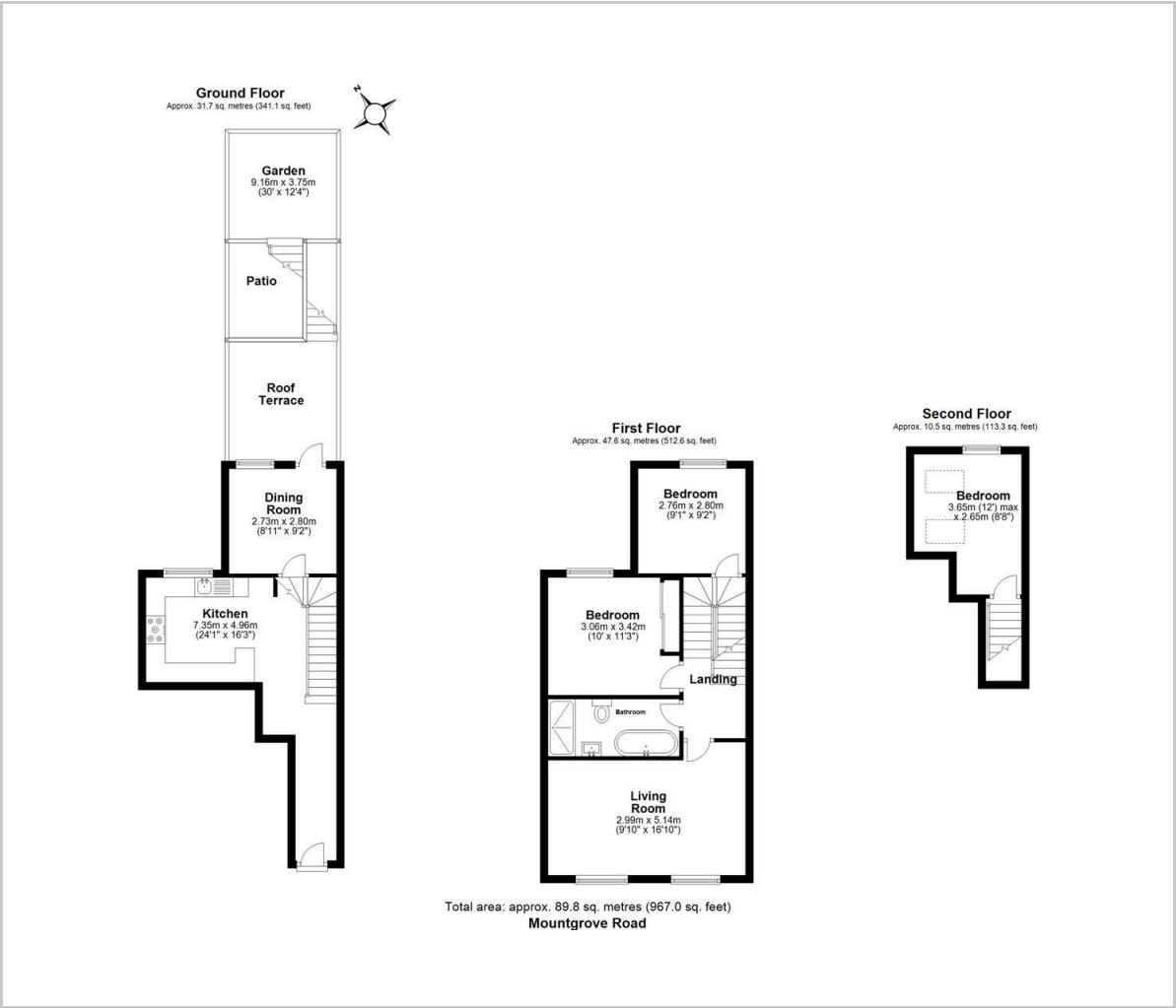

Viewing

Please contact our James Edward Office on 020 7952 5197 if you wish to arrange a viewing appointment for this property or require further information.

Area Map

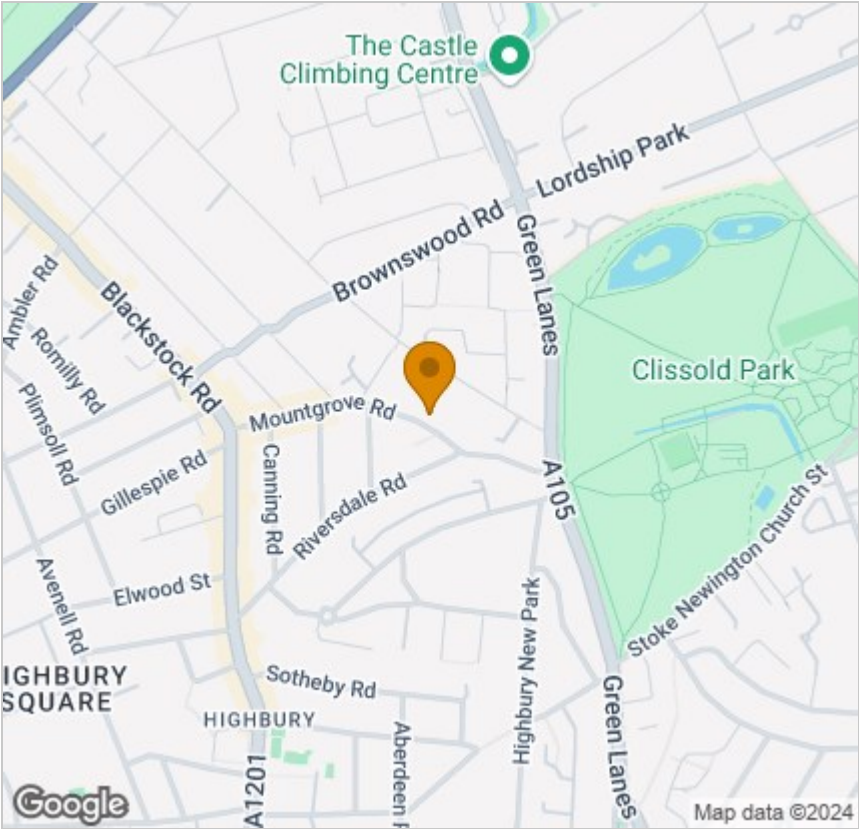

Energy Efficiency Graph

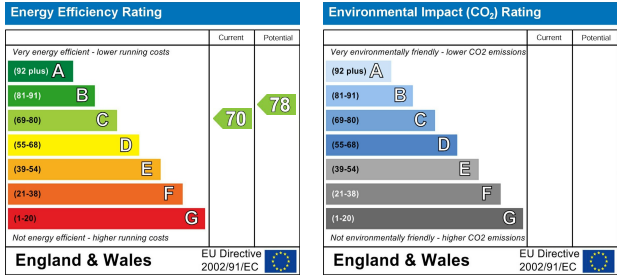

These particulars, whilst believed to be accurate are set out as a general outline only for guidance and do not constitute any part of an offer or contract. Intending purchasers should not rely on them as statements of representation of fact, but must satisfy themselves by inspection or otherwise as to their accuracy. No person in this firms employment has the authority to make or give any representation or warranty in respect of the property.

100 Highbury Park, London, N5 2XE
Tel: 020 7952 5197 Email: info@jamesedwardproperties.co.uk <https://www.jamesedwardproperties.co.uk>